

Locking interface

FB-VER-F-M-GR2270/71

Item 116237



ingun[®]

Partner for Future Technology

- Dock onto Pylon receiver without lifting the test fixture via the locking latch
- Reliable locking of the closure mechanism
- Manual operation of the locking slide

Application

The functional unit is used to dock test fixtures with a Pylon interface to the Pylon receiver without having to lift the test fixture via the receiver's locking latch. The locking mechanism is opened and closed manually by simply actuating the locking slide.



General data

| | |
|--------------------|---------------------------------|
| Product group: | Locking units |
| Series: | FB-RC |
| Type: | Locking unit for interface |
| Version: | GR2270/71 (manual) |
| Accessory type: | Additional function |
| Scope of delivery: | 2 x locking unit, pre-installed |
| Material: | 1.0037, galvanised |
| Width: | 29 mm [1.14 in] |
| Height: | 60 mm [2.36 in] |
| Weight: | 0.45 kg [.992 lbs] |
| Min. temperature: | 10 °C [50 °F] |
| Max. temperature: | 60 °C [140 °F] |
| RoHS-compliant: | Yes |

Compatible with

| | |
|--------------|---------------|
| Accessories: | SST-GR2270/71 |
|--------------|---------------|

Technical data

| | |
|---------------------------|--|
| Stroke: | 16 mm [.629 in] |
| Installation: | Bore D = 3.2 mm |
| Length: | 110 mm [4.33 in] |
| Outer dimensionS (WxDxH): | 110 x 29 x 60 mm [4.33 x 1.14 x 2.36 in] |

Locking interface FB-VER-F-M-GR2270/71

Item 116237



ingun[®]

Partner for Future Technology

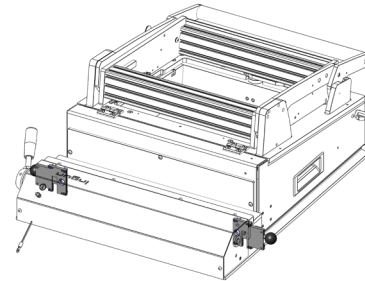
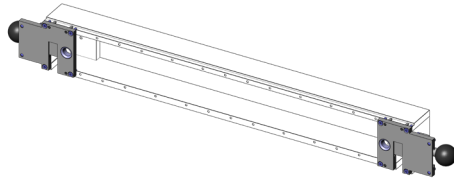

Accessories

| Part no. | Designation | Version |
|----------|---------------|---------------------|
| 109715 | SST-GR2270/71 | GR2270/71 interface |

INGUN Prüfmittelbau GmbH

Max-Stromeyer-Straße 162
78467, Constance, Germany
Phone +49 7531 8105-0
Customer hotline +49 7531 8105-888
Fax +49 7531 8105-65
info@ingun.com



Prices and delivery times on request.
Technical changes reserved. 12/25_GB

Learn more about
Test fixture kits

