

Test Probe

GKS-135 306 150 A 3000

Item GKS-135-0022



GO TO PRODUCT

ingun[®]

Partner for Future Technology

- Long-stroke test probe for implementing combined ICT and FCT in a dual-stage fixture
- For optimum contact at the test points (e.g. pads, vias, and pins), various tip styles in different diameters and finishes, as well as various spring forces are available.
- Used for setting the optimum stroke conditions in the test fixture, various installation heights can be achieved by combining test probes and receptacles

INGUN SELECTION

Note:

Receptacles in the series KS-100 are used for the GKS-135 test probes series.

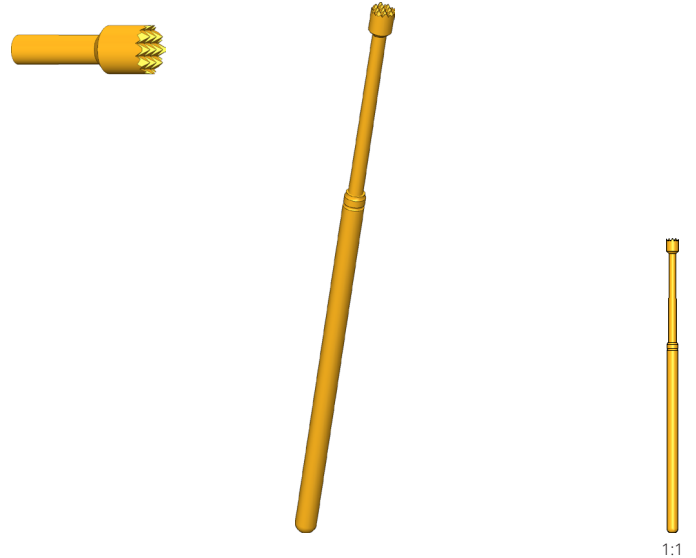

1:1

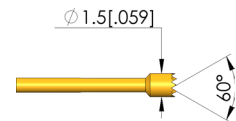
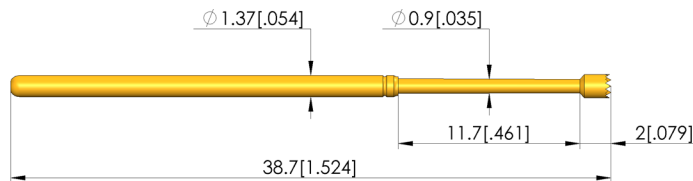
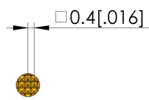

General data

Product group:
Sub-product group:
Series:
Grid:
Contacting from:
Magnetic:
Installation type:
Quick-exchange system:
Adjustable installation height:
Non-rotating:
Compatible receptacle(s):
Min. temperature:
Max. temperature:
RoHS-compliant:

ICT / FCT (in-circuit test and function test)
Long stroke GKS
GKS-135
2.54 mm [100 mil]
Post
Yes
Plug-in
Yes
No
No
KS-100
-40 °C [-40 °F]
80 °C [176 °F]
Yes

Tip style data

Tip style:
Tip diameter:
Tip style surface:
Tip style material:

06 serrated
1.5 mm [0.059 in]
A gold
3 CuBe

Electrical data

Current load capacity / rated current:
Typical resistance (Ri):

8 A
30 mOhm

Mechanical data

Total length:
Barrel diameter:
Maximum stroke:
Spring pre-load:
Collar height:
Spring force at working stroke:
Recommended working stroke:

38.7 mm [1.52 in]
1.37 mm [0.053 in]
11.5 mm [0.452 in]
0.37 N [1.33 ozf]
00
3 N [10.7 ozf]
9.3 mm [0.366 in]

Test Probe

GKS-135 306 150 A 3000

Item GKS-135-0022



ingun[®]

Partner for Future Technology

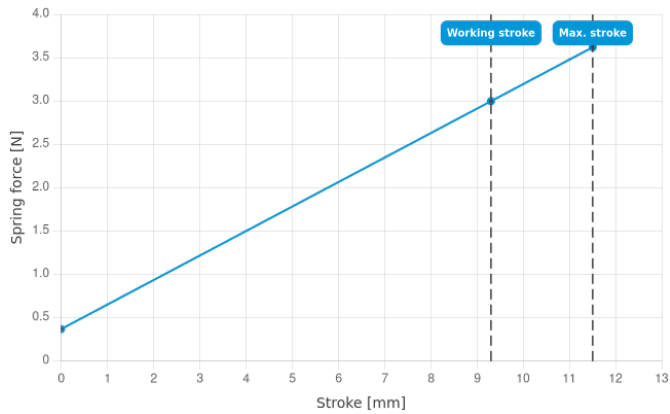

INGUN Prüfmittelbau GmbH

Max-Stromeyer-Straße 162
78467, Constance, Germany
Phone +49 7531 8105-0
Customer hotline +49 7531 8105-888
Fax +49 7531 8105-65
info@ingun.com



Prices and delivery times on request.
Technical changes reserved. 05/26_GB

Learn more about
ICT/FCT Test probes



ingun.com