

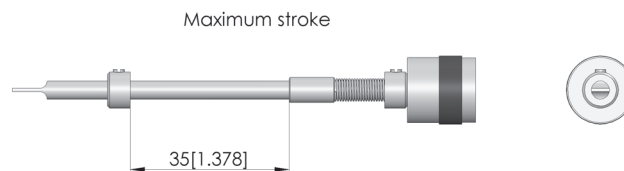

- For setting rotatable adjustable potentiometers during the test
- Space-saving, quick, easy installation
- Manual actuation

Application

With screwing units (SBE), space-saving alignment of adjustable screw-in devices can be performed during testing. Operation is manual. Screw-in units are typically mounted in the pressure frame plate.

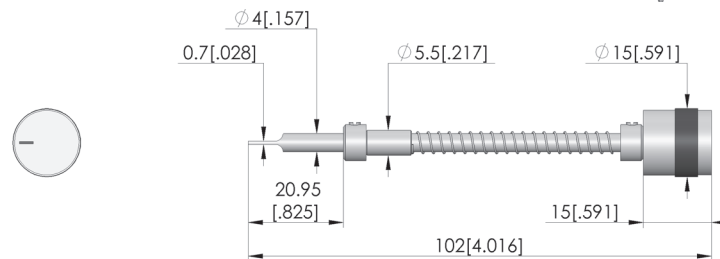
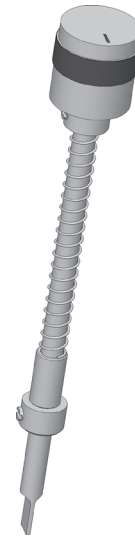

General data

Product group:
Series:
Type:
Version:
Accessory type:
Scope of delivery:
Min. temperature:
Max. temperature:
RoHS-compliant:

Screwing units
SBE

Manual, not vacuum-tight
Customising accessories

Incl. slotted bit
10 °C [50 °F]
60 °C [140 °F]
Yes

Compatible with

Manual test fixtures (MA):
MA exchangeable kits (ATS MA):
PA exchangeable kits (ATS PA):
For dual-stage contacting:

MA 2012
ATS MAxx
ATS PAZxxx
Yes

Technical data

Stroke:
Tip diameter:
Installation grid:
Blade dimensions (WxD):
Length:
Diameter:

35 mm [1.37 in]
15 mm [.59 in]
15 mm [.59 in]
4 x 0.7 mm [.157 x .027 in]
102 mm [4.01 in]
15 mm [.59 in]

INGUN Prüfmittelbau GmbH

Max-Stromeyer-Straße 162
78467, Constance, Germany
Phone +49 7531 8105-0
Customer hotline +49 7531 8105-888
Fax +49 7531 8105-65
info@ingun.com

