

Spring-loaded tooling pin

GFS-5,98-SW-12-08-B-G

Item 25217



GO TO PRODUCT

ingun[®]

Partner for Future Technology

- Trusted tooling pin for reliable, spring-loaded mounting of the PCB via the guide holes
- High-precision and low-wear
- Optimum tolerance compensation
- Compact design with internal spring

Application

Spring-loaded tooling pins (GFS) are used to spring-load the PCB to be tested via the guide holes and position it precisely in the probe field on the contacting plane.

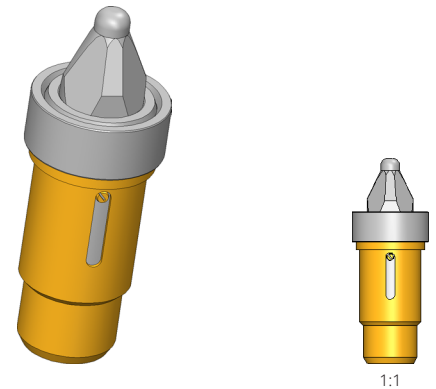

1:1

Note:

The spring-loaded tooling pin is mounted in the moving plate (ADP) and must be positioned with the collar flush to the surface of the moving plate.

Note:

Depending on the shape and tolerance accuracy of the PCB, tooling pin combinations with round/round or round/blade tip styles are used. The long side of the blade must always be aligned perpendicular to the distance of the hole.

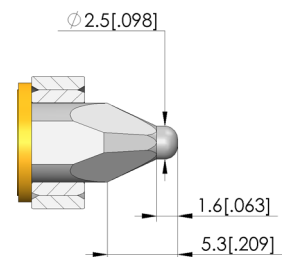
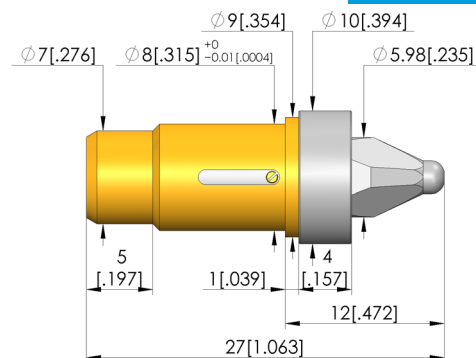
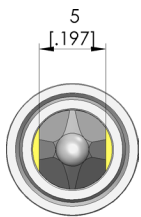

General data

Product group:
Series:
Type:
Version:
Accessory type:
Scope of delivery:
Weight:
Min. temperature:
Max. temperature:
RoHS-compliant:

Tooling pins
FS-GF
Spring-loaded
Sword with collar (D9x1), moving plate (ADP)
Customising accessories
Incl. friction bearing
0.01 kg [.022 lbs]
10 °C [50 °F]
60 °C [140 °F]
Yes

Compatible with

Exchangeable kits version:
Manual test fixtures (MA):
Vacuum test fixtures (VA):
MA exchangeable kits (ATS MA):
PA exchangeable kits (ATS PA):
For dual-stage contacting:

No limitations
MA 2012
VA 30xx
ATS MAxx
ATS PAZxxx
Yes

Technical data

Stroke:
Tip diameter:
Force:
Installation:
Spring force:
Length:
Tip height:
Diameter:
Pin diameter:

5 mm [.196 in]
5.98 mm [.235 in]
3 N [10.7 ozf]
Plugged
3 N [10.7 ozf]
27 mm [1.06 in]
5.3 mm [.208 in]
10 mm [.393 in]
8 mm [.314 in]

Spring-loaded tooling pin

GFS-5,98-SW-12-08-B-G

Item 25217



ingun[®]

Partner for Future Technology

Accessories

Part no.	Designation	Version
25215	GFS-5,98-RD-12-08-B-G	Spring-loaded tooling pin, tip style: round shaped

INGUN Prüfmittelbau GmbH

Max-Stromeyer-Straße 162
78467, Constance, Germany
Phone +49 7531 8105-0
Customer hotline +49 7531 8105-888
Fax +49 7531 8105-65
info@ingun.com



Prices and delivery times on request.
Technical changes reserved. 12/25_GB