

# High-current test probe

## HSS-003 319 254 A 3000

Item HSS-003-0003



GO TO PRODUCT

**ingun**<sup>®</sup>

Partner for Future Technology

- Trusted, robust high-current probes, optimally sized for current load capacity ratio
- Low-Ohm probe with Ri typical: < 10 mOhm
- For use in function and burn-in tests
- Large selection of tip styles and spring forces for optimum contact with DUT
- Optimum adjustment of the stroke ratios in the test fixture: The test probe collar is available in different heights, which, in combination with the receptacles, allows a range of installation heights

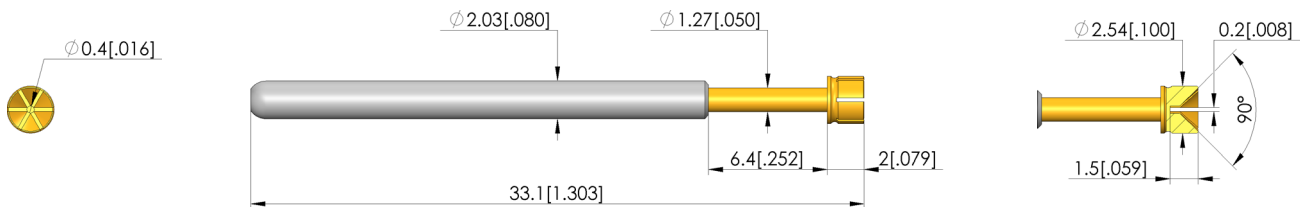
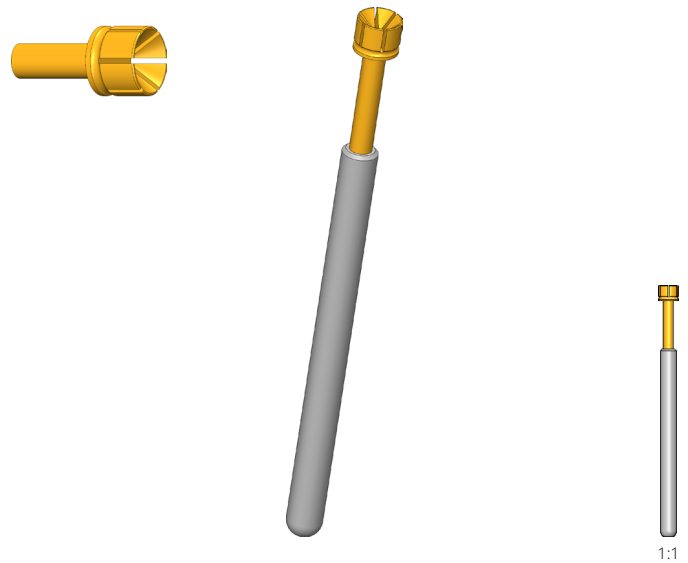

### General data

Product group:	International standard HSS
Sub-product group:	International standard HSS
Series:	HSS-003
Grid:	3.18 mm [125 mil]
Contacting from:	Post
Magnetic:	Yes
Installation type:	Plug-in
Quick-exchange system:	Yes
Adjustable installation height:	No
Non-rotating:	No
Compatible receptacle(s):	KS-003
Min. temperature:	-100 °C [-148 °F]
Max. temperature:	200 °C [392 °F]
RoHS-compliant:	Yes

### Tip style data

Tip style:	19 90° inverse cone, slotted, self cleaning
Tip diameter:	2.54 mm [.1 in]
Tip style surface:	A gold
Tip style material:	3 CuBe

### Electrical data

Current load capacity / rated current:	27 A
Typical resistance (Ri):	10 mOhm

### Mechanical data

Total length:	33.1 mm [1.3 in]
Barrel diameter:	2.03 mm [.079 in]
Maximum stroke:	6.35 mm [.25 in]
Spring pre-load:	0.8 N [2.87 ozf]
Collar height:	00
Spring force at working stroke:	3 N [10.7 ozf]
Recommended working stroke:	4.4 mm [1.73 in]

HIGH-CURRENT TEST PROBES

# High-current test probe HSS-003 319 254 A 3000

Item HSS-003-0003



GO TO PRODUCT

# ingun®

Partner for Future Technology

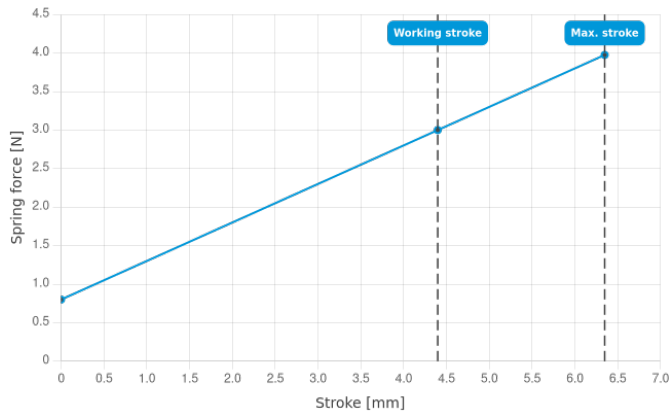

## INGUN Prüfmittelbau GmbH

Max-Stromeyer-Straße 162  
78467, Constance, Germany  
Phone +49 7531 8105-0  
Customer hotline +49 7531 8105-888  
Fax +49 7531 8105-65  
info@ingun.com



Prices and delivery times on request.  
Technical changes reserved. 03/26\_GB

Learn more about  
High-current test probes



HIGH-CURRENT TEST PROBES

ingun.com