

# Pneumatic magnet valve

## PMV-MG3/2-QS4-24V-100L

Item 32680



GO TO PRODUCT

**ingun**<sup>®</sup>

Partner for Future Technology

- Precise control of compressed air
- Quick reaction times thanks to combination of electronic activation and mechanical movement
- Reliable and durable, even under harsh conditions.
- Compact design, ideal for use in limited spaces

### Application

Pneumatic solenoid valves are used to control pneumatic drives in order to regulate or stop the flow of the required compressed air.

### Function

Pneumatic solenoid valves consist of a solenoid coil system and a valve mechanism. Applying voltage to the solenoid coil generates a magnetic field that actuates the valve mechanism. This controls the air flow.

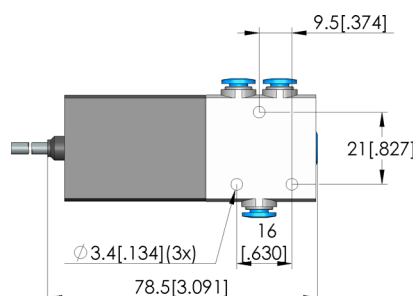
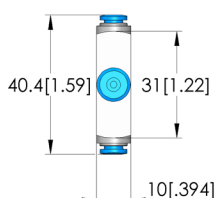
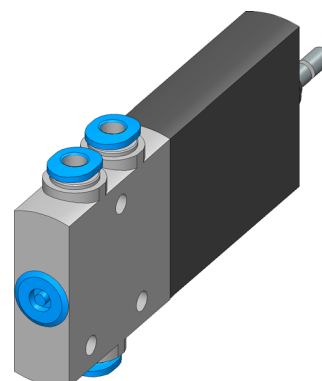

### General data

Product group:

Series:

Type:

Version:

Accessory type:

Material:

Width:

Height:

Weight:

Min. temperature:

Max. temperature:

RoHS-compliant:

Pneumatic accessory

PMV

Magnet valve

3/2 monostable, closed

Customising accessories

Zinc pressure die-casting

10 mm [0.393 in]

41 mm [1.61 in]

0.06 kg [0.132 lbs]

-5 °C [23 °F]

60 °C [140 °F]

Yes

### Compatible with

Accessories:

ME-P-Xx,0-16-054-QS4

### Technical data

Installation:

Max. voltage:

Number of poles:

Compressed air connection:

Rated flow:

Length:

Cable length:

Outer dimensionS (WxDxH):

Bore D = 3.4 mm

24 VDC

3

QS-4

100 l/min [26.4 gal/min]

73 mm [2.87 in]

2,500 mm [98.4 in]

73 x 10 x 41 mm [2.87 x 0.393 x 1.61 in]

### INGUN Prüfmittelbau GmbH

Max-Stromeyer-Straße 162

78467, Constance, Germany

Phone +49 7531 8105-0

Customer hotline +49 7531 8105-888

Fax +49 7531 8105-65

info@ingun.com



Prices and delivery times on request.  
Technical changes reserved. 12/25\_GB