

# Board marker probe ME-E-R2,0-12-080-S12V

Item 38371



GO TO PRODUCT

**ingun**<sup>®</sup>

Partner for Future Technology

- Compact, robust design
- Precise, adjustable positioning
- Permanent marking of various materials
- Outstanding service life, highly resistant to wear
- Electric drive system

**INGUN SELECTION**

## Application

The new ME-E board marker probe is used for reliable marking of tested electronic assemblies. It is installed in a test fixture or exchangeable kit, takes up little space, and can be precisely adjusted.

## Function

The spring-loaded marking engraver is pressed against the surface of the PCB during the test. The marking unit is supplied with current in the contacted state. The rotary movement generated by the current marks the PCB permanently.

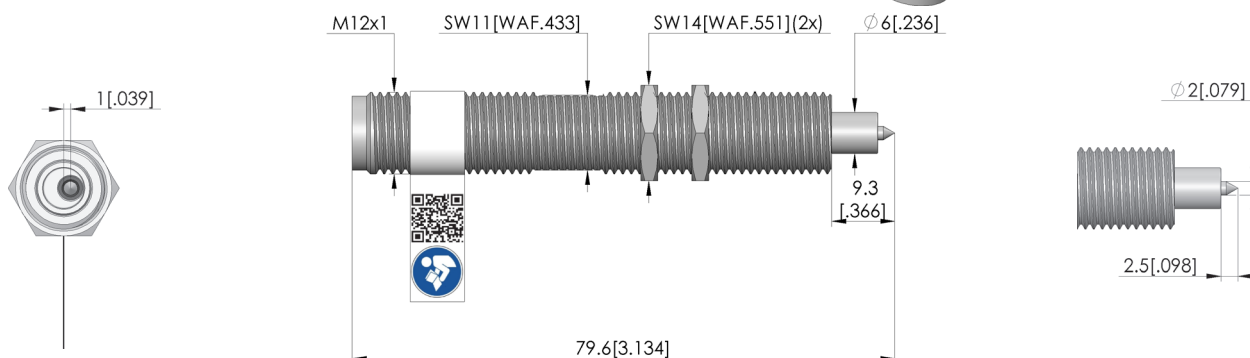
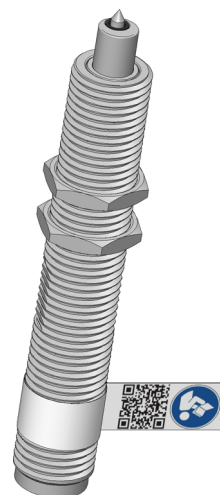

## General data

Product group: Board marker probes (ME)  
 Series: ME-E  
 Version: Electrical  
 Accessory type: Customising accessories  
 Outer dimensions (TxL): 12 x 80 mm [472 x 3.14 in]  
 Outer thread: M12 x 1  
 Lock nut width across flats: 14 mm [0.551 in]  
 Marking type: Circle  
 Approx. marking  $\phi$ : 2 mm [0.078 in]  
 Surface material: Hard / soft  
 Weight: 0.05 kg [0.11 lbs]  
 Min. temperature: -20 °C [-4 °F]  
 Max. temperature: 65 °C [149 °F]  
 RoHS-compliant: Yes

## Compatible with

Manual test fixtures (MA): MA 20xx  
 Vacuum test fixtures (VA): VA xxxx  
 MA exchangeable kits (ATS MA):  
 VA exchangeable kits (ATS VA): ATS VINxxx  
 PA exchangeable kits (ATS PA): ATS PAZxxx

## Technical data

Recommended working stroke: 1.5 mm [0.059 in]  
 Recommended marking impulse: 1 s  
 Maximum stroke (ME): 2 mm [0.078 in]  
 Approx. compression at working stroke: 3 N [10.7 ozf]  
 Marking tip: Scratching engraver  
 Engraver material: Solid carbide  
 Approx. engraver hardness: 1600 HV  
 Drive: Electric gear motor  
 Motor connection via: Plug connector  
 Rated voltage: 12 V DC  
 Rated output: 0.75 W  
 No-load current: 3.68 mA  
 Starting current: 106 mA  
 Connecting resistance: 114 Ohm  
 Max. load current: 81 mA  
 Max. torque: 54 mNm [477 lbf·in]  
 Approx. idle speed: 180 U/min  
 Noise emission: Not relevant

**BOARD MARKER PROBES**

# Board marker probe ME-E-R2,0-12-080-S12V

Item 38371



**ingun**<sup>®</sup>

Partner for Future Technology

## Accessories

Part no.	Designation	Version
27316	SWS-ME-E-R2,0	Engraver change set, scratching engraver for markings with D = 2.0 mm (including pressure spring 24454)
36797	ASV-ME-E-WK-EC	Extraction device
43637	ASK-M12-F-W-2000-0,34-004	Connector cable, M12x1, four-pole

## INGUN Prüfmittelbau GmbH

Max-Stromeyer-Straße 162  
78467, Constance, Germany  
Phone +49 7531 8105-0  
Customer hotline +49 7531 8105-888  
Fax +49 7531 8105-65  
info@ingun.com



Prices and delivery times on request.  
Technical changes reserved. 04/26\_GB

Learn more about  
Board marker probes



ingun.com