

# Contact terminal

## KT-S-039 67 21

Item KT-S039-0002



GO TO PRODUCT

ingun®

Partner for Future Technology

- Use of larger test probes for increased contacting accuracy and longer service life
- Compatible with existing socketless systems
- Variable installation height allows for optimal consideration of different test point levels

NEW

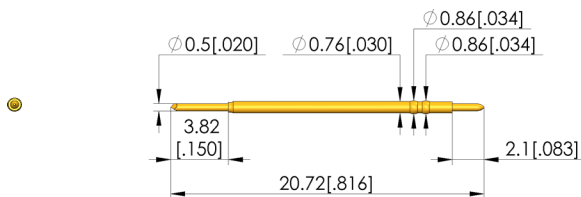
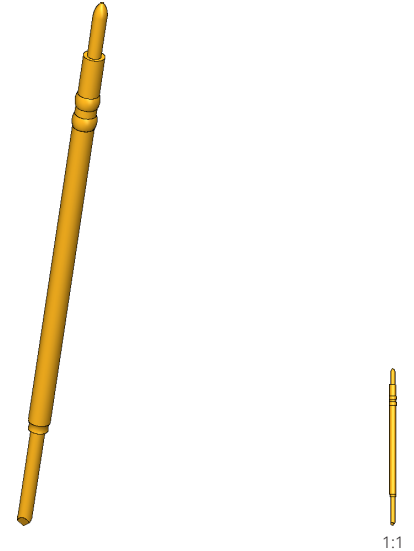

### General data

Product group:	Contact terminals (KT)
Series:	KT-S039
Sub-series:	KT-S039 standard
Grid:	1 mm [39.3 mil]
Type of contact terminal connection:	Wireless
Magnetic:	Yes
Installation type:	Press-in
Quick-exchange system:	No
Surface area:	A gold
Knurl:	No
RoHS-compliant:	Yes

### Tip style data

Tip diameter:	0.49 mm [0.019 in]
---------------	--------------------

### Mechanical data

Total length:	20.7 mm [0.815 in]
Shaft diameter:	0.76 mm [0.029 in]
Latching lug:	No

### Mounting hole

Mounting hole in CEM1:	0.8 – 0.82 mm [0.031 – .032 in]
Mounting hole in FR4:	0.8 – 0.82 mm [0.031 – .032 in]

### INGUN Prüfmittelbau GmbH

Max-Stromeyer-Straße 162  
78467, Constance, Germany  
Phone +49 7531 8105-0  
Customer hotline +49 7531 8105-888  
Fax +49 7531 8105-65  
info@ingun.com



Prices and delivery times on request.  
Technical changes reserved. 03/26\_GB

Learn more about  
Test probes



ingun.com