

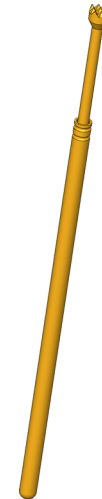

GO TO PRODUCT

- Well-established test probes for contacting PCBs
- For optimal contact to the test points (e.g. pads, vias, and pins), various tip styles with various diameters and finishes are available.
- Various spring forces available as well as versions with stainless steel springs suitable for high temperatures
- Used for setting the optimum stroke conditions in the test fixture, various installation heights can be achieved by combining test probes and receptacles



1:1

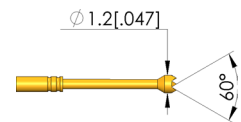
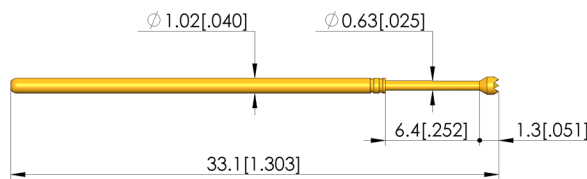
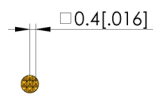

General data

Product group:
Sub-product group:
Series:
Grid:
Contacting from:
Magnetic:
Installation type:
Quick-exchange system:
Adjustable installation height:
Non-rotating:
Compatible receptacle(s):
Min. temperature:
Max. temperature:
RoHS-compliant:

ICT / FCT (in-circuit test and function test)
Standard stroke test probe
GKS-075
1.91 mm [75.1 mil]
Post
Yes
Plug-in
Yes
No
No
KS-075
-40 °C [-40 °F]
80 °C [176 °F]
Yes

Tip style data

Tip style:
Tip diameter:
Tip style surface:
Tip style material:

06 serrated
1.2 mm [.047 in]
A gold
3 CuBe

Electrical data

Current load capacity / rated current:
Typical resistance (Ri):

3 A
20 mOhm

Mechanical data

Total length:
Barrel diameter:
Maximum stroke:
Spring pre-load:
Collar height:
Spring force at working stroke:
Recommended working stroke:

33.1 mm [1.3 in]
1.02 mm [.04 in]
6.35 mm [.25 in]
0.6 N [2.15 ozf]
00
1.5 N [5.39 ozf]
4.3 mm [.169 in]

Test Probe

GKS-075 306 120 A 1500

Item GKS-075-0072



ingun[®]

Partner for Future Technology

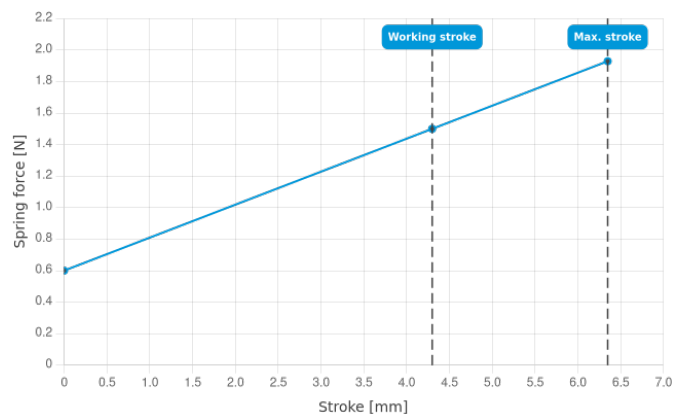

INGUN Prüfmittelbau GmbH

Max-Stromeyer-Straße 162
78467, Constance, Germany
Phone +49 7531 8105-0
Customer hotline +49 7531 8105-888
Fax +49 7531 8105-65
info@ingun.com



Prices and delivery times on request.
Technical changes reserved. 12/25_GB

Learn more about
ICT/FCT Test probes



ICT/FCT TEST PROBES

ingun.com