

Receptacle

KS-100 47 G12

Item KS-10047G12



GO TO PRODUCT

ingun[®]

Partner for Future Technology

INGUN SELECTION

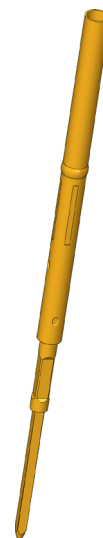

1:1

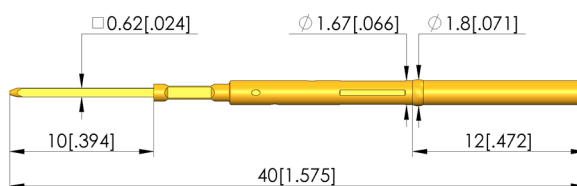

General data

Product group:
Series:
Sub-series:
Type of receptacle connection:
Press ring:
Surface area:
Collar diameter:
Collar height:
Wire-wrap post length:
Knurl:
Vacuum-tight:
RoHS-compliant:

Receptacles (KS)
KS-100
KS-100 press-in version
Wire-wrap
Yes
Gold
1.85 mm [.072 in]
12 mm [.472 in]
10 mm [.393 in]
No
yes (< 1 ccm / min)
Yes

Mechanical data

Total length: 40 mm [1.57 in]
Outer diameter: 1.67 mm [.065 in]

Mounting hole

Mounting hole in CEM1: 1.68 – 1.69 mm [.066 – .066 in]
Mounting hole in FR4: 1.69 – 1.7 mm [.066 – .066 in]
Mounting hole with press ring in CEM1: 1.7 – 1.75 mm [.066 – .068 in]
Mounting hole with press ring in FR4: 1.7 – 1.75 mm [.066 – .068 in]

INGUN Prüfmittelbau GmbH

Max-Stromeyer-Straße 162
78467, Constance, Germany
Phone +49 7531 8105-0
Customer hotline +49 7531 8105-888
Fax +49 7531 8105-65
info@ingun.com



Prices and delivery times on request.
Technical changes reserved. 04/26_GB

Learn more about
Test probes



ingun.com